

# XPEDITION HYBRID

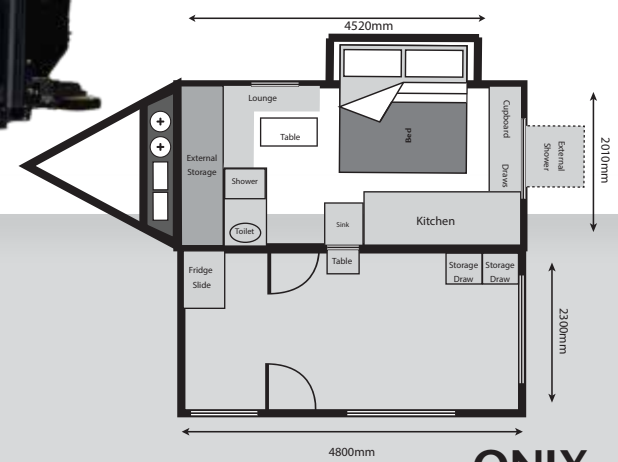

1300 594 000

[BLUEWATERCAMPERS.COM.AU](http://BLUEWATERCAMPERS.COM.AU)

ONLY  
**\$56,990\***

\*Registrations, Dealer and Delivery charges may apply

# XPEDITION

## HYBRID CAMPER

ONLY  
\$56,990\*

\*Registrations , Dealer and Delivery charges may apply

### GENERAL SPECIFICATIONS

Tare - 2150kg including standard features	ATM - 2900kg
Payload - 750kg	Ball Weight - 180kg
Wheel Track - 1775mm	

Dimensions - (L) 6.4m x (W) 2.1m x (H) 2.45m

### TENT SPECIFICATIONS

Annex with Roof, Walls, Wind Flaps, Floor, verandahs & Poles included

Heavy Duty 'Close Weave' 440g/m2 (15.5oz)

Self repairing zippers to all windows & doors

Awnlux Side Mounted pull out style awning with anti flap kit

Drop down Bagged Shower Ensuite

Dual entry door with flyscreen mesh

Windows Tinted Inside Flyscreen and Blockout Blinds

### SLEEPING

Sleeping accomodation for 4

Queen Size 15cm Pocket Spring Mattress with Memory Foam Topper

Top Bunk 1800x600mm, Bottom Bunk 1600x600mm

### ELECTRICAL

Multiple 12v & USB sockets, inside and out

240V fully installed by local certified electrician with 15A inlet

Anderson plug connectors for vehicle and solar input for extra panel

2 x 135ah BSL Lithium batteries with built in BMS

Redarc BMS 30 with Redvision

350W Redarc Invertor

12V & Water Level Indicator Gauges

2 x 175W Victron Solar Panels

24" Smart TV with Winegard Antenna

AM/FM/CD/MP3/Bluetooth Stereo with internal & external speakers

HB9000 2.2kw cooling, 1.8kw heating, Reverse cycle air conditioner mounted under seat

Electric Emergency Breakway with 2 ADR Compliant Safety Chains

Automatic Roof Actuators with manual override

Truma Ultra Rapid Hot Water 14l sotrage unit, gas & 240v

### STORAGE

Fridge Slide: 975mm long x 560mm wide x 540mm high

Generator Slide: 705mm long x 495mm wide x 650mm high

Provision for Rear bike rack tongue / receiver

2 x 9kg gas bottle holders & 2 x Jerry Can tie downs

### TRAILER SPECIFICATIONS

Fully Aluminium RHS frame with composite panel cladding, Underbody Sealer, Proof Coated with Mud Flaps

12" Electric Drum Brakes with Mechanical Handbrake

RHS Galvanised Chassis 100x50x4mm Proof Coated

Cruisemaster DO35 Hitch 3.5T and trailer plug included to suit your tow vehicle

Drawbar RHS Galvanised 150x50x3mm Q345 - with water tap mounted

750kg rated ARK XO Off Road Dual Wheel Jockey Wheel

4 'drop down' adjustable stabiliser legs

Padded Stone Guard

Adjustable Independent Heavy Duty Coil Springs with Twin RidePro Shock Absorbers

265/75 R16 AT Tyres on Alloy Rims, 2 x rear mounted spares

1 x 200ltr Fresh water tank & 1 x 120ltr Grey water tank, including mains water connection

Outside cooking Thetford Topline 3 burner Stove, SS sink, dish drainer, 12v Light & inside sink

External BBQ Bench with gas Bayonet fitting

Internal shower with Thetford Toilet and roof mounted vent. Outside hand shower.

2 x rear Heavy Duty recovery shackles

Seaflo Water Pump with John Guest Hose and Fittings

Dust Suppression System Fitted

ALL PRODUCT INFORMATION, SPECS AND PRICING CORRECT AT TIME OF PRINTING AND MAY BE CHANGED BY THE MANUFACTURER WITHOUT NOTICE. PLEASE CHECK WITH YOUR CUSTOMER SERVICE REPRESENTATIVE FOR ANY UPDATES. - ABN: 94 005 451 007



VISIT OUR WEBSITE FOR UPGRADES LIST AND PHOTO GALLERY

**BLUEWATERCAMPERS.COM.AU**

**1300 594 000**

## VISIT US AT ONE OF OUR SHOWROOMS

### VICTORIA

31 Commercial Drive  
Pakenham, VIC 3810  
T: (03) 5945 5300

### NEW SOUTH WALES (MD072927)

39-41 Shelley Road  
Moruya, NSW 2537  
T: (02) 4413 2622

### QUEENSLAND

9 Indy Court  
Carrara, QLD 4211  
T: (07) 3333 1952

### WESTERN AUSTRALIA (MD273923)

46 Stebbing Road  
Maddington, WA 6109  
T: (08) 6244 2077

### SOUTH AUSTRALIA (AGENT)

Barossa Off-Road  
3/27 Theen Ave  
Willaston, SA 5118  
T: (08) 8522 1141

### ALBURY/WODONGA (AGENT)

Albury/Wodonga 4x4  
1/4 Kane Road  
Wodonga, VIC 3690  
T: (02) 6056 1138



EAGLE PART OF THE OUTDOORS GROUP