

XTRAVELLER HYBRID

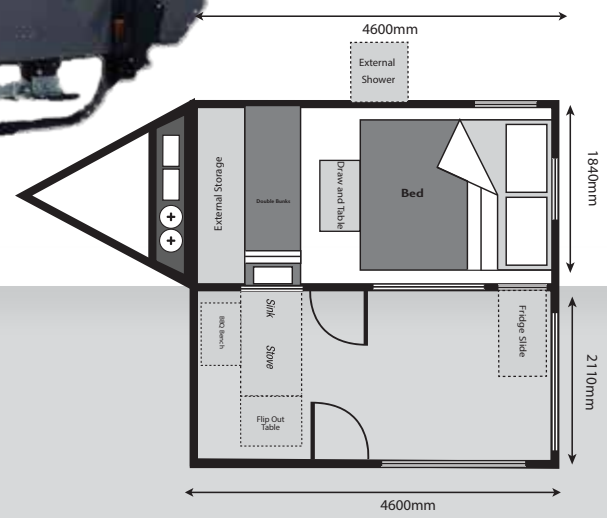

1300 594 000

BLUEWATERCAMPERS.COM.AU

ONLY
\$41,990*

*Registrations, Dealer and Delivery charges may apply

XTRAVELLER

HYBRID CAMPER

ONLY
\$41,990*

*Registrations , Dealer and Delivery charges may apply

GENERAL SPECIFICATIONS

Tare - 1750kg including standard features

ATM - 2400kg

Payload - 650kg

Ball Weight - 200kg

Dimensions - (L) 5.9m x (W) 1.95m x (H) 2.2m

TENT SPECIFICATIONS

Annex Roof, Walls, Wind Flaps, Floor, Verandahs & Poles included

Heavy Duty 'Close Weave' 440g/m2 (15.5oz)

Self repairing zippers to all windows & doors

Awnlux Side mounted pull out style awning with Anti Flap Kit

Drop down Bagged Shower Ensuite

Windows Tinted Inside Flyscreen and Blockout Blinds

SLEEPING

Sleeping Accommodation for 4

Queen Size Pocket Spring Mattress & high density foam in bunks

Bunk Bed - 1700x650mm

ELECTRICAL

Multiple 12v & USB sockets, inside and out

240V fully installed by local certified electrician with 15A inlet

2 x 135ah BSL Lithium Batteries with in built BMS

Redarc BMS 30 with Redvision

12V & Water Level Indicator Gauges

2 x 175W Victron Solar Panels

Electric Emergency Breakaway with 2 ADR Compliant Safety Chains

Truma Ultra Rapid Hot Water 14l sotrage unit, gas & 240v

AM/FM/CD/MP3/Bluetooth Stereo with internal & external speakers

STORAGE

Multiple storage Compartments inside & out - including huge under bed storage

Fridge Slide: 1230 long x 580 high x 540 wide

Provision for Rear bike rack tongue / receiver

Rear Pole Box Storage fitted

2 x gas bottle holders & Jerry Can tie downs

TRAILER SPECIFICATIONS

Fully Welded Aluminium Body with composite panel cladding, Underbody Sealer, Proof Coated with Mud Flaps

Drawbar Full Length RHS Galvanised 120x50x4mm

RHS Galvanised Chassis 75x50x4mm Proof Coated

Cruisemaster DO35 Hitch 3.5T and trailer plug included to suit your tow vehicle

12" Electric Drum Brakes with Mechanical Handbrake

750kg rated ARK XO Off Road Dual Wheel Jockey Wheel

4 'drop down' adjustable stabiliser legs

Adjustable Independent Heavy Duty Coil Springs with Twin RidePro Shock Absorbers

Dual rear rated Heavy Duty recovery shackles

4 x 265/75 R16 AT Tyres on 6 Stud Alloy Rims

200ltr Total Water Tank capacity (F-80ltr & R-120ltr)

Theftord Stove, sink, dish drainer, 12v Light, bench Extension & Australian LPG Compliance. Hot Water Plumbed

External Hand Shower

Seaflor Water Pump with John Guest Hose and Fittings

Dust Suppression System Fitted

ALL PRODUCT INFORMATION, SPECS AND PRICING CORRECT AT TIME OF PRINTING AND MAY BE CHANGED BY THE MANUFACTURER WITHOUT NOTICE.
PLEASE CHECK WITH YOUR CUSTOMER SERVICE REPRESENTATIVE FOR ANY UPDATES. - ABN: 94 005 451 007



VISIT OUR WEBSITE FOR UPGRADES LIST AND PHOTO GALLERY

BLUEWATERCAMPERS.COM.AU

1300 594 000

VISIT US AT ONE OF OUR SHOWROOMS

VICTORIA

31 Commercial Drive
Pakenham, VIC 3810
T: (03) 5945 5300

NEW SOUTH WALES (MD072927)

39-41 Shelley Road
Moruya, NSW 2537
T: (02) 4413 2622

QUEENSLAND

9 Indy Court
Carrara, QLD 4211
T: (07) 3333 1952

WESTERN AUSTRALIA (MD27393)

46 Stebbing Road
Maddington, WA 6109
T: (08) 6244 2077

SOUTH AUSTRALIA (AGENT)

Barossa Off-Road
3/27 Theen Ave
Willaston, SA 5118
T: (08) 8522 1141

ALBURY/WODONGA (AGENT)

Albury/Wodonga 4x4
1/4 Kane Road
Wodonga, VIC 3690
T: (02) 6056 1138



EAGLE PART OF THE
OUTDOORS GROUP