

XPANDA MKII

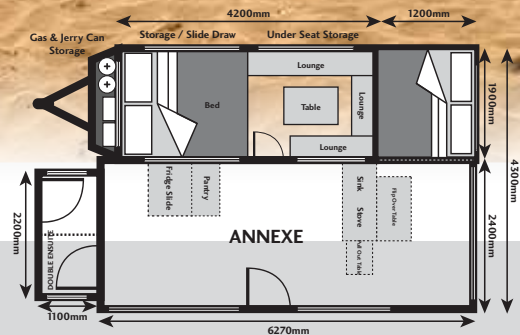

1300 594 000

BLUEWATERCAMPERS.COM.AU

ONLY
\$29,990*

*Registrations, Dealer and Delivery charges may apply

XPANDA MKII

FORWARD FOLD CAMPER

ONLY
\$29,990*

*Registrations , Dealer and Delivery charges may apply

GENERAL SPECIFICATIONS

Tare - 1900kg including standard features

ATM - 2400kg

Ball Weight - 120kg (empty)

Dimensions - (L) 5.8m x (W) 2.2m x (H) 1.71m

TENT SPECIFICATIONS

Annex Roof, Walls, Wind Flaps, Floor & poles included

SBS Zippers and high quality mesh screens

PVC Vinyl quick dry ensuite

Internal canvas privacy window screens / external canvas awning windows

Interior LED lights with dimmer

SLEEPING

Dual Density Memory Foam Mattress Queen Size

2 x Double Foam Mattresses

Bed Reading Lights fitted on each side

Privacy Wall supplied to Main Bed

ELECTRICAL

2 x 135AH Lithium Batteries

Multiple 12v sockets, USB points and DC sockets

Management control panel with water level gauges, volt meter, rocker switches and 50amp fuse

240V charging system with Victron IP67 Bluetooth 25a AC Charger

MP5 touch display screen sound system with AM/FM and 4 x speakers

STORAGE

Multiple storage compartments inside and out

Fridge slide: 980mm(L) x 610mm(W) x 540mm(H) with cable track system and one touch slide operation, LED lighting and extraction fan

Huge under bed storage with 3 drawers

Slide out kids bed storage cupboards

Angled front storage box, including padded PVC stone deflection guard

Rear Pole Storage Compartment

Rear Spare twin wheel carrier

TRAILER SPECIFICATIONS

Independent Coil Springs, with RidePro Shock Absorbers

ARK - X0 series off road jockey wheel rated to 750kg

Alloy 16" wheels with 265/75R16 Tyres

Cruisemaster DQ35 tow coupler

2 x 20L Jerry can tie downs

2 x Gas bottle holders

2 x water tanks with Seaflo 42 series pump (Total 210L capacity)

Mains Pressure water inlet with limiting valve

Smarttek Black Instant hot water system

Stainless steel kitchenette with theford gas stove, Australian plumbed & certified

4 'drop down' adjustable stabiliser legs

12" Electric Drum Brakes with Mechanical Handbrake

Cargo Rack fitted with gas struts for easy access

ALL PRODUCT INFORMATION, SPECS AND PRICING CORRECT AT TIME OF PRINTING AND MAY BE CHANGED BY THE MANUFACTURER WITHOUT NOTICE.
PLEASE CHECK WITH YOUR CUSTOMER SERVICE REPRESENTATIVE FOR ANY UPDATES. - ABN: 94 005 451 007

VISIT OUR WEBSITE FOR UPGRADES LIST AND PHOTO GALLERY

BLUEWATERCAMPERS.COM.AU

1300 594 000



VISIT US AT ONE OF OUR SHOWROOMS

VICTORIA
31 Commercial Drive
Pakenham, VIC 3810
T: (03) 5945 5300

NEW SOUTH WALES (MD072927)
39-41 Shelley Road
Moruya, NSW 2537
T: (02) 4413 2622

QUEENSLAND
9 Indy Court
Carrara, QLD 4211
T: (07) 3333 1952

WESTERN AUSTRALIA (MD29134)
46 Stebbing Road
Maddington, WA 6109
T: (08) 6244 2077

SOUTH AUSTRALIA (AGENT)
Barossa Off-Road
3/27 Theen Ave
Willaston, SA 5118
T: (08) 8522 1141

ALBURY/WODONGA (AGENT)
Albury/Wodonga 4x4
1/4 Kane Road
Wodonga, VIC 3690
T: (02) 6056 1138

