

MURCHISON

HYBRID

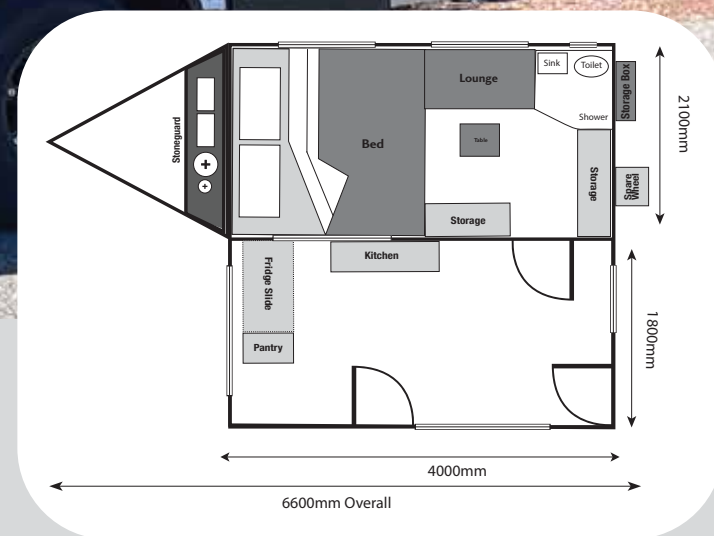

FITTED WITH QUALITY COMPONENTS

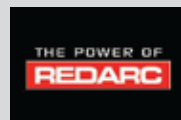

1300 594 000

BLUEWATERCAMPERS.COM.AU

ONLY
\$59,990*

*Registrations , Dealer and Delivery charges may apply

MURCHISON

HYBRID CAMPER TRAILER

ONLY
\$59,990*

*Registrations , Dealer and Delivery charges may apply

GENERAL SPECIFICATIONS

Tare - 2200kg including standard features

ATM - 3000kg

Payload - 800kg

Ball Weight - 200kg

Dimensions - (L) 6.6m x (W) 2.2m x (H) 3.08m

LIVING AREAS

Fully Enclosed Annex with Roof, Walls, Side Skirt, PVC Floor

Heavy Duty 'Close Weave' Canvas 440g/m² (15.5oz) waxed and proofed

Self repairing zippers to all Annex windows & doors

Awning with anti flap kit included

Split Dual entry door with flyscreen mesh

Large Ensuite with Composting Toilet, Shower and other amenities

Windows Tinted, Inside Flyscreen and Blockout Blinds

Sleeping accommodation for 2

Super King Size 22cm Pocket Spring Mattress with Memory Foam Topper Size 195cm wide x 195cm long

Bench Style seating with long adjustable Table

Reading lights either side of bed with 12v socket & USB Connection

ELECTRICAL

600ah Lithium Batteries with in built BMS - Option for up to 900ah

800W Mono Crystalline Solar Panels

Redarc Manager Alpha 50 BMS with Redvision Display

Redarc 2000W RS3 Pure Sine Wave Inverter with Pass through to 240V system

Truma Ultra Rapid Hot Water 14 litre storage unit, Operates on Gas & 240v

Dometic Fresh Jet Ultra Lite 2.6kw Inverter Airconditioner - Roof Mounted

240V fully installed by local certified electrician with 15A inlet

24" Engalon Smart TV with built in Chromecast and BT Connection

Premium MP5 Stereo Unit 7" Screen with integrated 4 Speaker Entertainment System & Bluetooth

12V 3speed Gimbal Fan 360 degree range x 2

Anderson plug connectors for vehicle and solar input for extra panels

Electric Emergency Breakaway with 2 ADR Compliant Safety Chains

Multiple 12v & USB sockets, inside and out

Water Level Indicator Gauges For each Fresh Water and Grey water Tank

Internal and External LED Lights with Orange Insect Repellent option

185L Upright Fridge Fitted with 73L Freezer

ALL PRODUCT INFORMATION, SPECS AND PRICING CORRECT AT TIME OF PRINTING AND MAY BE CHANGED BY THE MANUFACTURER WITHOUT NOTICE.
PLEASE CHECK WITH YOUR CUSTOMER SERVICE REPRESENTATIVE FOR ANY UPDATES.

STORAGE

Multiple storage Compartments inside & out

Fridge Slide: 920mm long x 600mm wide x 560mm high

Provision for Rear bike rack tongue / receiver

2 x 4kg gas bottle holders stored in weatherproof compartment

Batteries are stored external to the living area

TRAILER SPECIFICATIONS

OPTIONAL AIRBAG SUSPENSION

Heavy Duty Coil Springs paired with Adjustable Independent Suspension

Lovells Gas Shock Absorbers Heavy Duty 16mm Eye

Diesel Heater 2kw Plumbed with 10l tank

Thetford 3 Burner Stove Combination with sink, dish drainer, 12v Light, bench Extension & Gas Compliance

External Kitchen fully plumbed water and electrics, no manual connections required

Fold down pantry with multiple storage areas

4 'drop down' adjustable stabiliser legs - Optional ARK Jack Legs available

Cruisemaster DQ35 Hitch 3.5T and trailer plug included to suit your tow vehicle

Swing down Aluminium Entry step

Rock Sliders each side to protect underbody

Dual rear rated 4.5T Heavy Duty recovery shackles

265/75 R16 MT or AT Tyres on Alloy Rims, Rear mounted spare Tyre with Toolbox (second spare opt)

200ltr Total Fresh Water capacity (F-80ltr & R-120ltr) + 80lt Grey Water Tank - Poly Food Grade Tanks

John Guest water hoses and Fittings, Watermarked Food Grade safe.

Drawbar Mounted Water tap

Seaflo 9.5lm Water Pump with John Guest Hose and Fittings

Seaflo Mains water connection with Pressure Reducing Valve

Fully Welded Aluminium Body, Underbody Sealer, Proof Coated with Mud Flaps

Drawbar Full Length RHS Galvanised 150x50x4mm

RHS Galvanised Chassis 100x50x4mm Proof Coated

12" Electric Brakes with Mechanical Handbrake and Electric breakaway

ARK XO 750kg rated Off Road Dual Wheel Jockey Wheel

LIFETIME CHASSIS AND DRAWBAR WARRANTY



VISIT OUR WEBSITE FOR UPGRADES LIST AND PHOTO GALLERY

BLUEWATERCAMPERS.COM.AU

1300 594 000

VISIT US AT ONE OF OUR SHOWROOMS

WESTERN AUSTRALIA (MD31555)

19 Gillam Drive
Kelmscott, WA 6111
T: (08) 6244 2077

VICTORIA (AGENT)

Eagle Outdoors
2/55 Sette Circuit
Pakenham, VIC 3810
T: (03) 5945 5300

SOUTH AUSTRALIA (AGENT)

Barossa Off-Road
3/27 Theen Ave
Willaston, SA 5118
T: (08) 8522 1141

ALBURY/WODONGA (AGENT)

Albury/Wodonga 4x4
5 Kendall Street
Wodonga, VIC 3690
T: (02) 6056 1138

